



Exhibitor and Patron Prospectus

Where Sensor Manufacturers and Customers Meet

IEEE SENSORS 2014 will be held in Valencia, Spain, November 2-5, 2014. The venue for IEEE SENSORS 2014 is the Valencia Conference Center in the historic city of Valencia, close to the city's historic centre which hosts ancient monuments, views, and attractions. Valencia is one of Spain's most dynamic and popular cities for visitors.

IEEE SENSORS 2014 is intended to provide a forum for research scientists, engineers, and practitioners throughout the world to present their latest research findings, ideas, and applications in the area of sensors and sensing technology. IEEE SENSORS 2014 will include keynote addresses and invited presentations by eminent scientists. The Conference solicits original state-of-the-art contributions as well as review papers.

IEEE SENSORS 2014 will bring approximately 800 sensor and sensor systems practitioners together to interact and network with colleagues, learn of the latest sensor technology innovations, and meet the vendors of sensors and sensor systems that supply products and solutions to technical needs. The exhibition will be closely integrated with the technical program through workshops and tutorials, plenary sessions, industrial panels, sensor and sensor systems demonstrations, industrial innovation sessions, and social activities for delegates and exhibitors alike.

To begin the booking process for exhibiting at IEEE SENSORS 2014 contact us today!

Additional information can be found at <http://www.ieeesensors2014.org/>.

Publicity Chair: Edward Grant, North Carolina State University, egrant@ncsu.edu

Exhibits Manager: Lauren Pasquarelli, Conference Catalysts LLC, lauren@conferencecatalysts.com



Information for Exhibitors and Patrons

IEEE SENSORS 2014 will bring approximately 800 sensor and sensor systems practitioners together in Valencia, Spain. Sponsored by the IEEE, the world's largest professional association for the advancement of technology, IEEE SENSORS 2014 combines a robust and comprehensive exhibits program, lectures on the latest sensors and sensor technology, sessions that allow the interaction with leaders in the field, and a social program that will allow all delegates to take advantage of Valencia's cultural and gastronomic attractions that are close to the Conference Centre's prime location.

The IEEE SENSORS 2014 exhibits program is closely integrated with the technical program. The Exhibits Hall has a total area of 2290 m² and is adjacent to the auditorium and break-out meeting rooms, allowing easy flow between technical sessions and exhibits. Coffee breaks take place in the Exhibits Hall, ensuring maximum exposure for exhibitors. Exhibitors and patrons also have speaking opportunities before large audiences. Exhibitors' job opportunities will be advertised on the IEEE SENSORS 2014 website, reaching outstanding graduate students and all delegates who attend IEEE SENSORS 2014 thereby creating onsite interview opportunities.

Exhibits Run November 3-5, 2014

Exhibiting at IEEE SENSORS 2014 is a cost effective way for companies, large and small, to gain exposure in front of current and future world leaders in sensors and sensor systems.



Exhibitors at the IEEE SENSORS 2013 Conference

Exhibition Schedule

Action Item	Day	Start
Exhibitor Move In	Sunday, November 2	1.00pm-6.00pm
Exhibitor Hours	Monday, November 3	8.00am-5.00pm
Exhibitor Hours	Tuesday, November 4	8.00am-5.00pm
Exhibitor Hours	Wednesday, November 5	8.00am-3.00pm
Exhibitor Move Out	Wednesday, November 5	3.00pm

Exhibitor and Patron Packages

IEEE SENSORS 2014 provides four exhibitor and patron packages: Booth Only, Bronze, Silver, and Gold. The benefits of each package are summarized below.

	Exhibitor	Silver Patron	Gold Patron	Platinum Patron
3x2m booth, lighting, power, vinyl name, carpeting	1	1	2	3
Exhibitor booth staff badges	x	x	x	x
Discounted conference registration(s)	1	2	3	4
Company logo, description, and link to job openings on IEEE SENSORS 2014 website	x	x	x	x
Listed as exhibitor on printed materials	x	x	x	x
Listed as exhibitor/patron on website and printed materials		x	x	x
Three-minute teaser presentation at the end of speaking sessions		1	2	3
Identified as exhibitor/patron on monitors during the conference		x	x	x
Identified as exhibitor/patron in electronic proceedings of technical papers		x	x	x
Industrial tutorial speaking slot (free to attendees)			Regular	Keynote
One-page ad inserted in conference bag			x	
Pamphlet advert inserted in conference bag				x
VIP dinner ticket				x
Logo with home link on IEEE SENSORS 2014.org home page				x
One-minute company video (Super Bowl ad) before plenary				x
Customized access to a meeting room (interviews, hospitality)				x
	\$2,000	\$5,000	\$10,000	\$15,000

Your Exhibitor Fee Includes

- 1 – 3x2m walled booth
- Lighting
- 3.3kw power supply
- Company name vinyl
- Carpeting

Additional Patron Opportunities (non-exclusive)

If your company would like to be an exclusive patron, please contact Exhibits Manager, Lauren Pasquarelli, Conference Catalysts LLC, (USA), Tel: +1-352-872-5544, Fax: +1-352-872-5545
Email: lauren@conferencecatalysts.com

- Lanyard **(\$2,000)** *exclusive patronship and production included
- Banquet at the Valencia Conference Centre **(\$4,000)**
- Opening and Closing receptions at the Valencia Conference Centre **(\$2,000 each)**
- The awards lunch **(\$2,000)**
- Explore Valencia social event **(\$2,000)**
- Coffee Breaks **(\$1,200)**
- One Page ad in the Conference Bag **(\$1,200)** *production not included

Your company will be recognized on signage onsite at the specific event for which you are the patron

For More Information

For more information on exhibiting and patronships at IEEE SENSORS 2014 contact Exhibit Manager, Lauren Pasquarelli, Conference Catalysts LLC, Tel: +1-352-872-5544, Fax: +1-352-872-5545, Email: lauren@conferencecatalysts.com

Official Conference Dates

November 2 - 5, 2014

Conference Location

**Valencia Conference Centre
Avda. Cortes Valencianas, 60
Valencia, 46016
Spain**

Tel: +34-(96)-317-9400, Fax: +34-(96)-317-9401
Email: palcon@palcongres-vic.com
Website: www.palcongres-vic.com

The IEEE SENSORS 2014 conference location has a: total function space of 4628 m², total exhibits space of 2290 m², 2218 theatre/auditorium seating, and 11 break-out/meeting rooms.

The nearest airport to the conference location is Valencia Airport VLC and is 10 minutes away.

Hotels adjacent to the conference location have a total of 1000 rooms available for delegates.

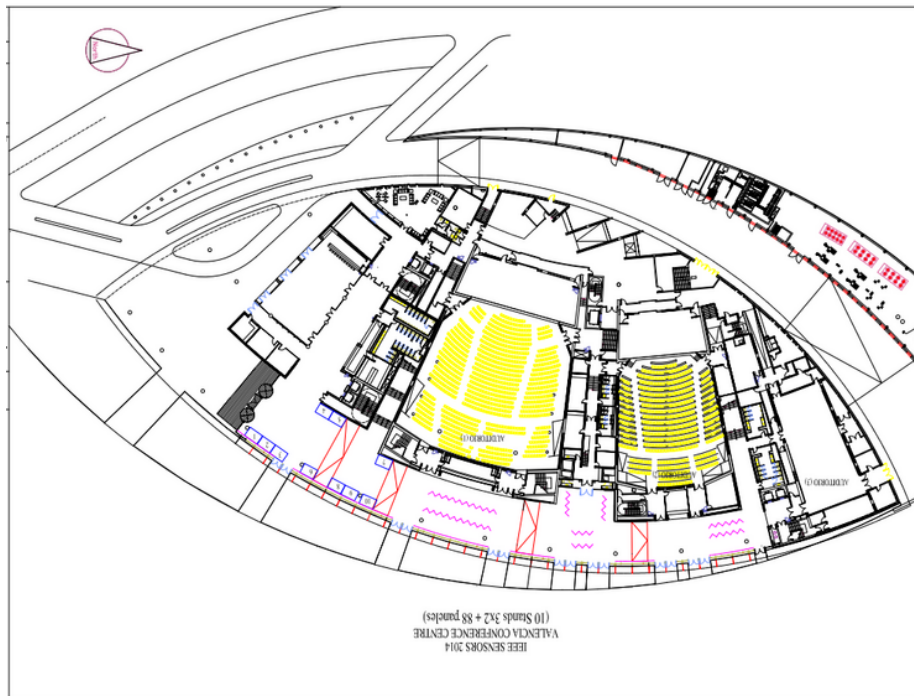

Floor Plan of the Valencia Conference Center Showing the Exhibition Area and Booth Locations

EXHIBIT SPACE & PATRON APPLICATION/CONTRACT

1. Please read this contract carefully and print or type all information requested.

2. Complete, sign and send to: **Lauren Pasquarelli**
Conference Catalysts LLC
802 NW 16th Ave, Suite B
Gainesville, FL 32601
USA
Tel: +1-352-872-5544
Fax: +1-352-872-5545
Email: lauren@conferencecatalysts.com

Booth license charge is **\$2,000 per 3x2m booth**.

Exhibitor: Booth Only \$2,000 [] Silver \$5,000 [] Gold \$10,000 [] Platinum \$15,000 []

Additional Patronship: _____ \$ (USD) _____

Choice	Booth#	# of booths
1 st	_____	_____
2 nd	_____	_____

[] First Time Exhibitor (Check Here)

Payment of \$2,000 per3x2m booth is due with contract submission. Exhibitor and Patronship item payment is due within 30 days of receipt of contract submission.

COMPANY INFORMATION

Company Name _____ Mailing _____
Address _____ City _____
State _____ Zip _____ Country _____ Telephone _____ Web Address _____

I have read and agree to the terms and conditions of this contract.

Signature _____ Date _____
Print Name _____ Title _____

CONTACT INFORMATION

Contact Name _____ Email _____
Telephone _____ Fax _____
Mailing Address (If different from above) _____

PAYMENT INFORMATION

Check [] (Make checks payable to: **"IEEE SENSORS 2014"**) Credit Card [] Wire Transfer []
Contact Lauren Pasquarelli, Conference Catalysts LLC, lauren@conferencecatalysts.com for complete payment info

All payment information will be kept strictly confidential. Credit card payment will be used only once and destroyed after processing

Terms and Conditions

1. Contract

This application, properly executed by applicant (exhibitor) shall upon written acceptance and notification of booths assigned by IEEE SENSORS 2014 management constitute a valid and binding contract.

2. Assignment of Space

Assignment of space to exhibitors and those making application will be made in the order of date and time received. IEEE SENSORS 2014 will continue to receive applications and assign exhibit space, as it remains available, until shortly before the show opening date. In all cases, total booth payments must be received prior to show opening. IEEE SENSORS 2014 assignment of booths is final and shall constitute an acceptance of the exhibitor's offer to occupy space. After assignment, space location may not be changed, transferred or canceled by the exhibitor except upon written request and with the subsequent written approval of IEEE SENSORS 2014 management. IEEE SENSORS 2014 management reserves the right to reassign exhibitor space in order to modify floor plan for overall benefit of the show.

3. Subletting Space

No exhibitor will assign, sublet, or apportion the whole or any part of the space allotted to him, nor exhibit therein, nor permit any other person or party to exhibit therein, any other goods, apparatus, etc. not manufactured or distributed by the exhibitor in the regular course of his business except upon prior written consent of IEEE SENSORS 2014 management.

4. Exhibit Space Rental Rates

Exhibit space rental includes materials and services described herein. Show price per 3x2m space contracted at \$2,000.

5. Payment Requirements and Cancellation Charges

Applications require full payment before booths are assigned. Payment in full is required with submission of contract application or on the date indicated on the invoice. All cancellations must be made in writing and will be based on the following

Schedule of refunds:

After August 7, 2014 but before October 7, 2014:

Refund of 50% of the total license fee for cancellation

On or after August 7, 2014:

No refund or credit at any time.

It is understood that IEEE SENSORS 2014 reserves the right, at its option, to reassign a cancelled booth regardless of the cancellation rate assessed. In the event that the premises in which the IEEE SENSORS 2014 show is conducted shall become, in the sole discretion of IEEE SENSORS 2014, unfit for occupancy, or substantially interfered with by reason of any cause or causes not reasonably within the control of IEEE

SENSORS 2014, this agreement may be terminated by IEEE SENSORS 2014. For this purpose, the term "cause or causes" shall include, but not by way of limitation, fire, flood, epidemic, earthquake, explosion or accident, blockage, embargo, inclement weather, governmental restraints, restraints or orders of civil defense, or military authorities, act of public enemy, riot or civil disturbance, strike, lockout, boycott or other labor disturbance, inability to secure sufficient labor, technical, or other personnel, failure, impairment or lack of adequate transportation facilities, inability to obtain, or condemnation, requisition or commandeering of necessary supplies or equipment, local, state or federal law, ordinance, rule, order, decree or regulation, whether legislative, equipment, local, state or federal law, ordinance, rule, order, decree or regulation, executive, or judicial, and whether constitutional, or act of god. Should IEEE SENSORS terminate this agreement pursuant to the provision of this paragraph the exhibitor waives any and all claims for damages and agrees that IEEE SENSORS 2014 may, after computing the total amount of IEEE SENSORS 2014 cost and expenses in connection with its preparation for and conducting of the IEEE SENSORS 2014 event, (including a reasonable reserve for claims and other contingencies), refund to the exhibitor, as and for complete settlement and discharge of all said exhibitor's claims and demands, and amount which bears the same relationship to the fee paid by said exhibitor as the total refundable amount as computed above bears to the total amount of fees paid by all exhibitors.

6. Exhibit Booth Manning and Dismantling Schedule

A representative must man exhibit space during all times when exhibition is officially open. Exhibit space must be maintained in a neat and orderly manner throughout the exhibition. Exhibitors may begin dismantling only after hours stated in exhibitor service manual. Exhibitors are responsible for removal of all materials used in their display. Any exhibitor leaving materials after hours stated in exhibitor service manual will be charged for the materials' removal.

7. Losses or Damage

Exhibitor agrees that IEEE SENSORS 2014 shall not be liable for any damage or liability of any kind or for any loss, damage or injury to persons or property during the term of this agreement, from any cause whatsoever by reason of use, occupation and enjoyment of exhibit space by exhibitor or any person thereon with the consent of exhibitor, and that exhibitor will defend, indemnify and save harmless, IEEE SENSORS 2014 from all liability whatsoever, on account of any such damage, or injury, whether or not caused by negligence of or breach of an obligation by exhibitor or its employees or representatives. Exhibitor will be liable for all damages, or liability of any kind or for any loss, damage or injury to persons or any property during the

show from any cause whatsoever by reason of use, occupation and enjoyment of exhibit space.

8. Demonstrations

No demonstrations or solicitations shall be permitted outside of the exhibitor's assigned space, and no signs or placards may be displayed on persons or otherwise outside exhibit spaces.

9. Compliance

The exhibitor assumes all responsibility for compliance with all pertinent ordinances, regulations and codes of duly authorized local, state and federal governing bodies concerning fire, safety and health, together with the rules and regulations of the operators and/or owners of the property wherein the show is held.

10. Policy

It is further agreed that the exhibitor will abide by and comply with rules and regulations concerning local customs that may apply, having agreements with the show Facility or with authorized contractors employed by IEEE SENSORS 2014.

11. Management

The exhibitor further agrees that the conditions, rules and regulations of the IEEE SENSORS 2014 management are made a part of this contract and that said exhibitor agrees to be bound by each and all of these rules and regulations, and that the management shall have the full power to interpret, amend and enforce all rules and regulations in the best interest of the show.

12. Alteration of Booth Space

IEEE SENSORS 2014 management shall be entitled to alter the layout if, in their opinion, this is in the general interest of the exhibition.